

For Flight Simulation and non commercial use only!
Courtesy of Austro Control GmbH

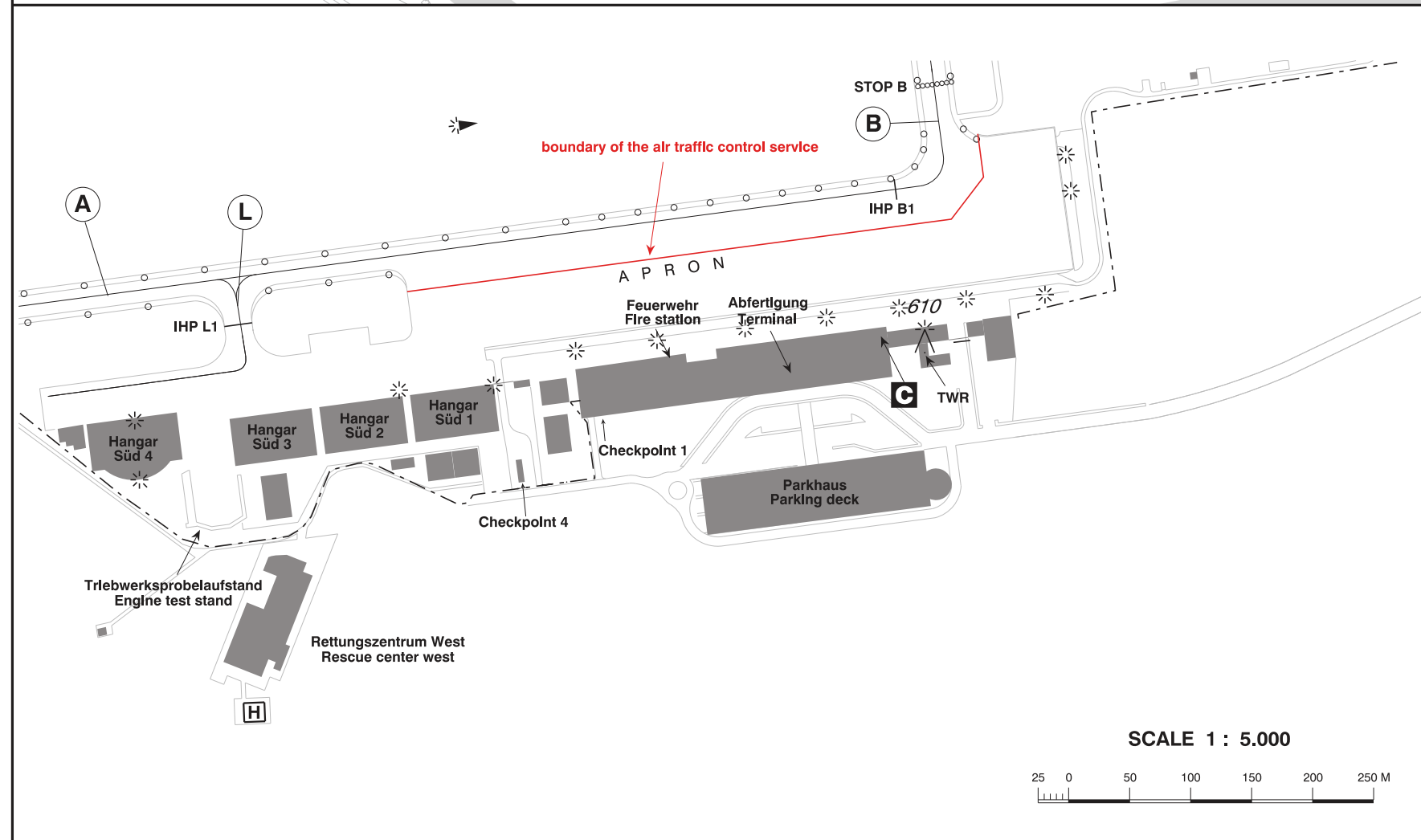
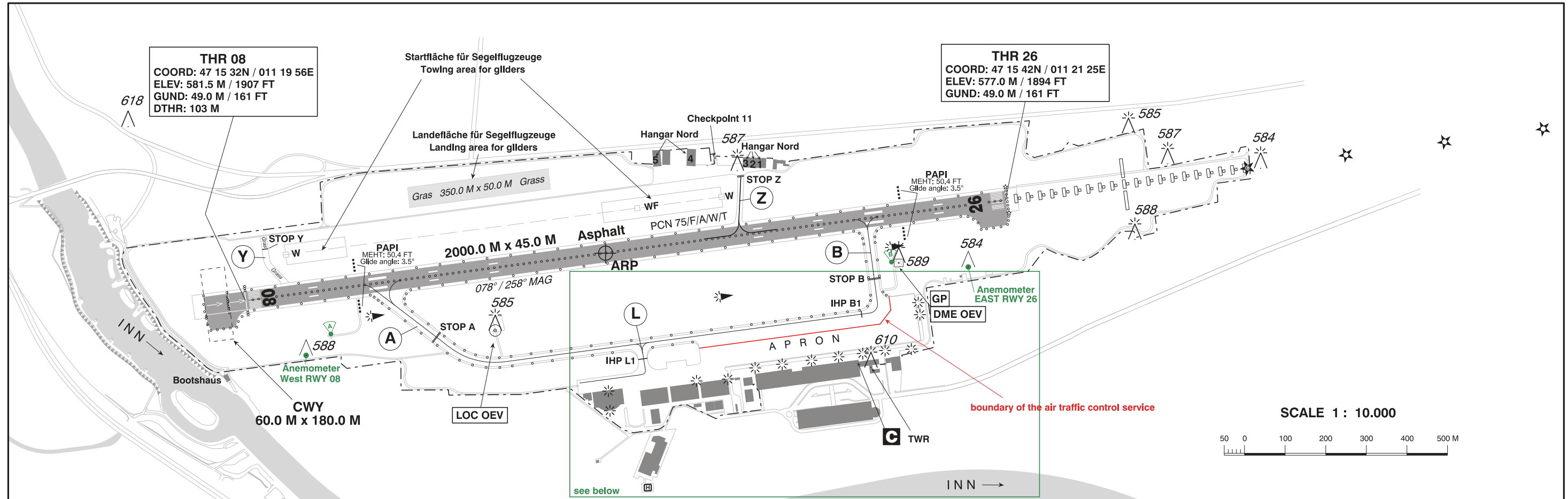

| | |
|-------|------------|
| Radar | 119.270Mhz |
| Tower | 120.100Mhz |
| Atis | 126.020Mhz |

**HÖHEN IN METERN
ELEVATIONS IN METRES**

↑
VAR 3° E (2020)
ANNUAL RATE OF CHANGE 0.1° E