

SCALE 1 : 10.000

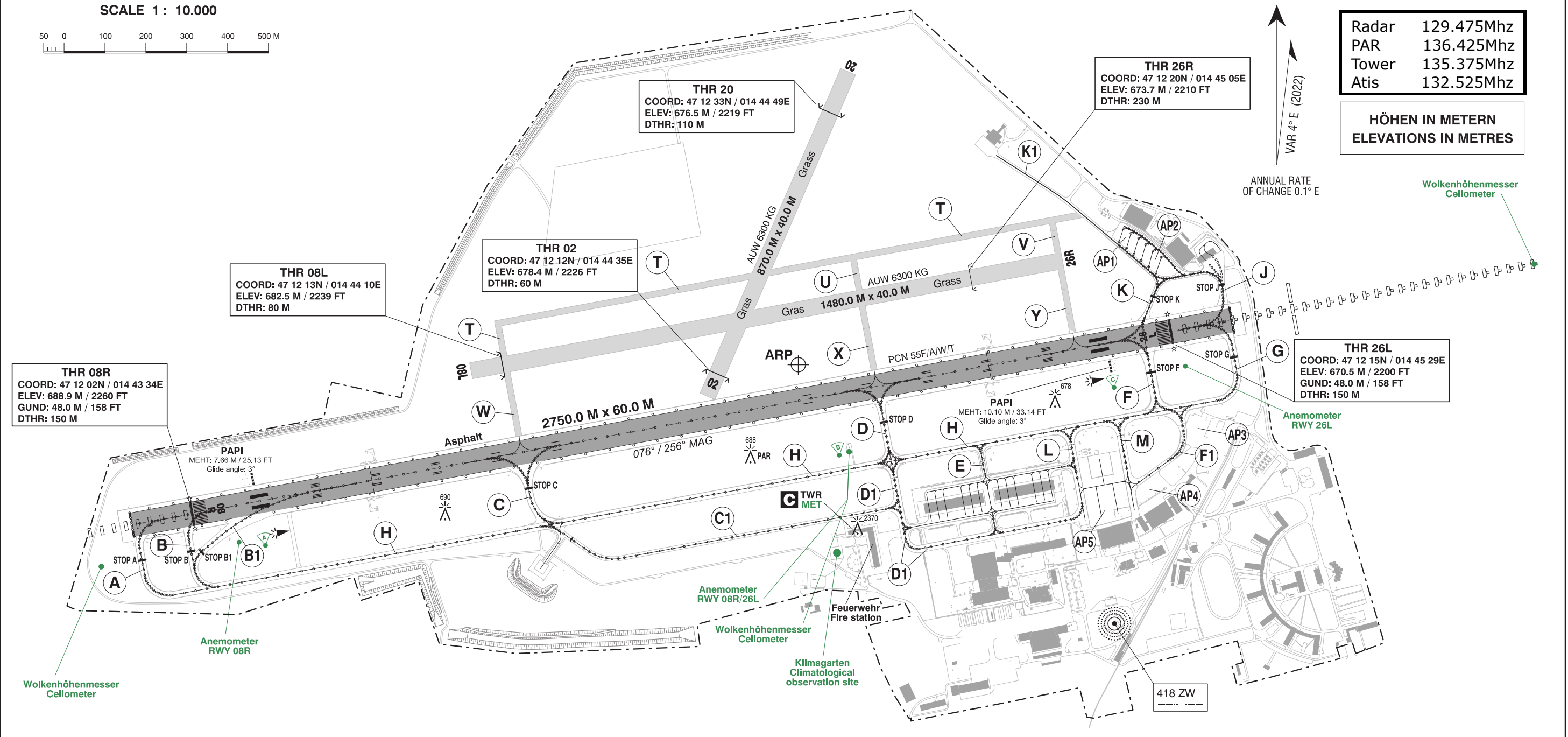

Radar	129.475Mhz
PAR	136.425Mhz
Tower	135.375Mhz
Atis	132.525Mhz

HÖHEN IN METERN  
ELEVATIONS IN METRES

VAR 4° E (2022)  
ANNUAL RATE OF CHANGE 0,1° E

Wolkenhöhenmesser  
Cellometer

Anemometer  
RWY 26L

Anemometer  
RWY 08R/26L

Wolkenhöhenmesser  
Cellometer

Klimagarten  
Climatological  
observation site

Feuerwehr  
Fire station

418 ZW

For Flight Simulation and non commercial use only!  
Courtesy of Austro Control GmbH

vacc  
AUSTRIA

INS COORDINATES

PSN	LAT	LONG
THR 26L	47 12 15.10N	014 45 28.60E
THR 08R	47 12 02.02N	014 43 33.88E
STOP RWY 26L/08R TWY A	47 11 58.40N	014 43 27.87E
STOP RWY 26L/08R TWY B	47 11 59.05N	014 43 33.63E
STOP RWY 26L/08R TWY B1	47 11 58.97N	014 43 34.87E
STOP RWY 26L/08R TWY C	47 12 03.57N	014 44 13.21E
STOP RWY 26L/08R TWY D	47 12 08.32N	014 44 54.85E
STOP RWY 26L/08R TWY F	47 12 11.89N	014 45 26.17E
STOP RWY 26L/08R TWY G	47 12 13.00N	014 45 35.92E
STOP RWY 26L/08R TWY J	47 12 18.78N	014 45 34.68E
STOP RWY 26L/08R TWY K	47 12 17.94N	014 45 26.63E

RWY TWY TORA (M) TODA (M) ASDA (M)

08R	B	2562	2562	2562
	B1	2309	2309	2309
	C	1690	1690	1690
	D	840	840	840
26L	C	882	882	882
	D	1810	1810	1810
	F	2475	2475	2475
	K	2470	2470	2470

Anmerkungen: / Remarks:

- Abweichungen von ICAO Doc 9157:
- Hindernisfreiheit TWY H zwischen B und C 37M
  - Hindernisfreiheit TWY J 19M.
- Deviations from ICAO Doc 9157:
- Obstacle clearance TWY H between B and C 37M
  - Obstacle clearance TWY J 19M.